

1. Maintenance of fill valve

Malfunction and solve way of fill valve

malfunction	solve way
1. The water level too high or too low	Adjust water level
2. Can not stop water	Wash sealed rubber and mandril
3. Fill water speed slow	Wash filter; Adjust water stress to higher
4. Others questions	Pls consult with professional technician

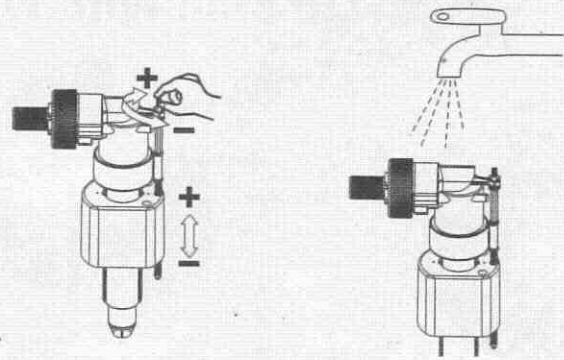

① Turn the knob, adjust water level height.

② Wash the dirt

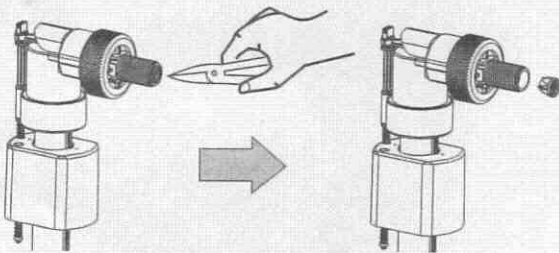

③ Take off the filter tip and clean

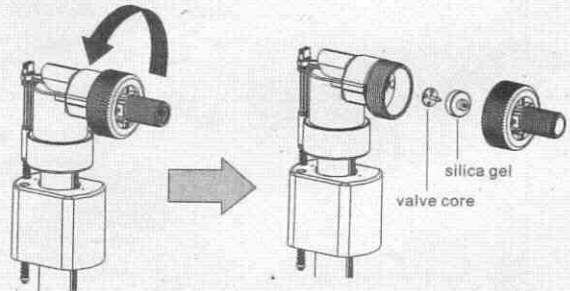

④ Wring the screws widdershins and clean or place the valve core and the silica gel of fill valve

2. Maintenance of flush valve

Malfunction and solve way of flush valve

malfunction	reason	solve way
1. Can not flush water	The flush pole distortion or break	Replace the flush pole
	The working water level too low	Adjust the working water level
1. Apear leak	The sealed rubber can not seal water	Replace the sealed rubber
	The movement of flush valve is blocked	Wash the dirt of flush valve

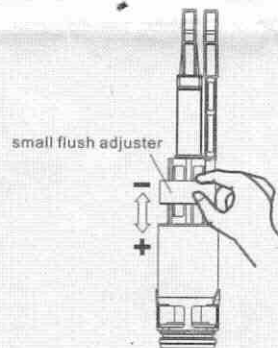

① Adjust the small flush water volume by adjust the small-flush adjuster.

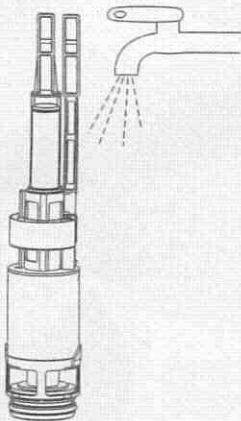

② Wash the dirt of flush valve by flowing and clean water.

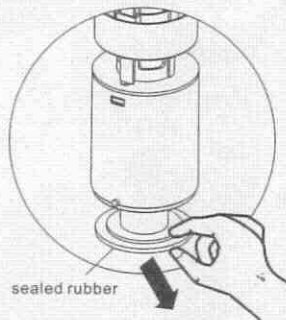

③ Take out of the silica gel of flush valve, clean or replace it.

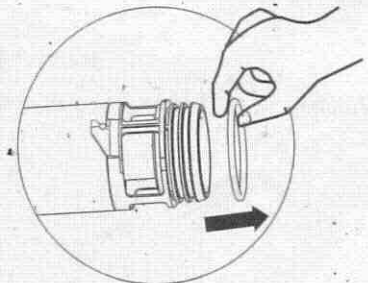

④ Take out of the sealed rubber of flush valve, clean or replace it.

Attention: The process of installation is opposite to the process of teardown. Pls install the valve carefully according to original shape after clean or replace it.