

Instruction Manual of Concealed Cistern (Install With Wall Hung Toilet)

1. Fitting chart

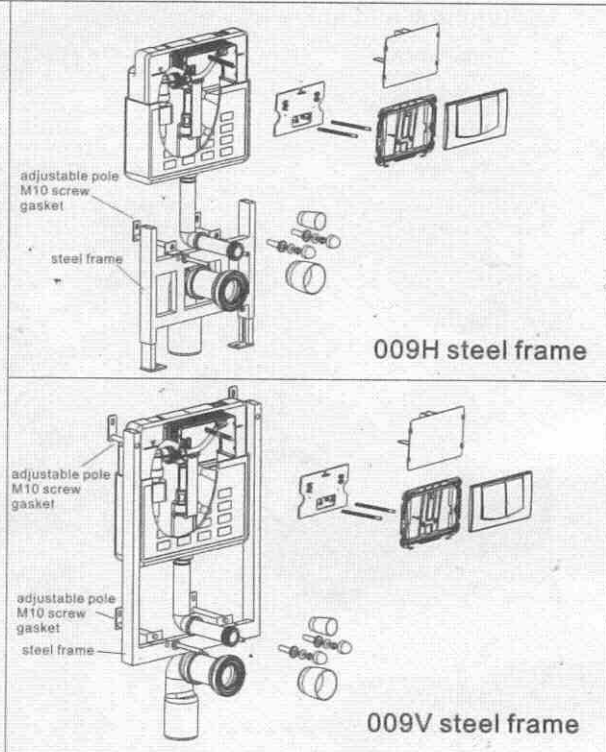

2. Technologic data:

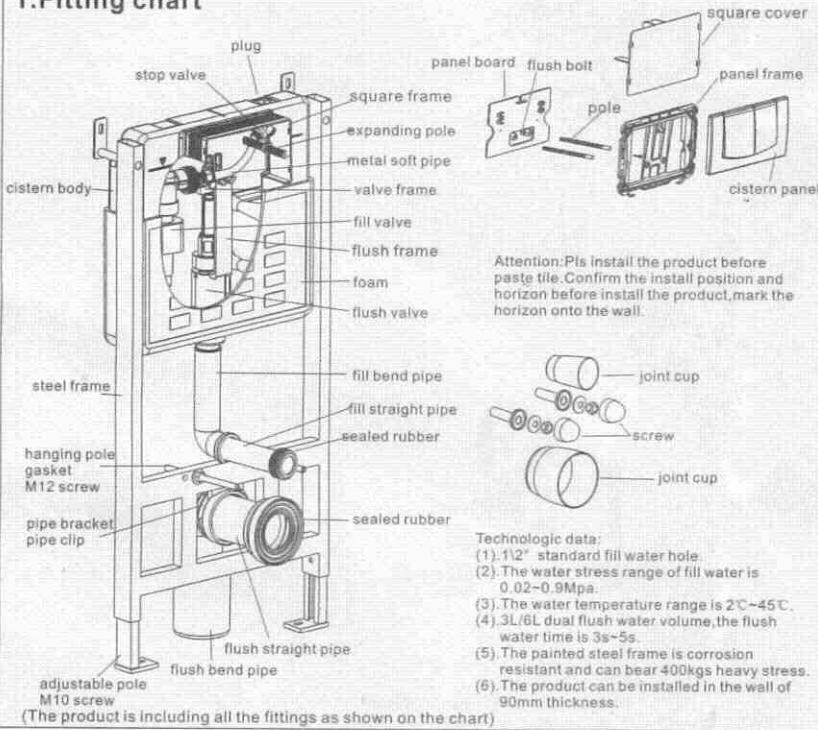
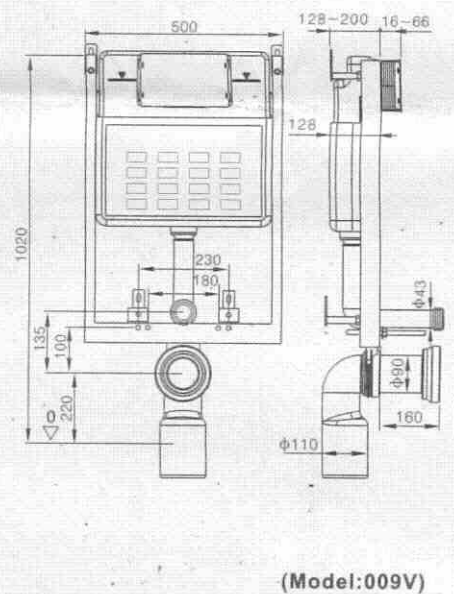
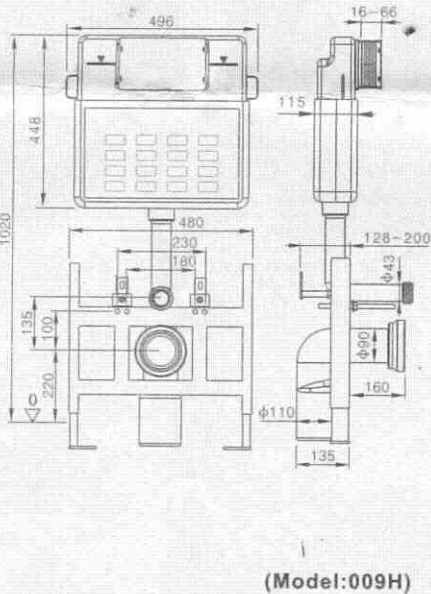
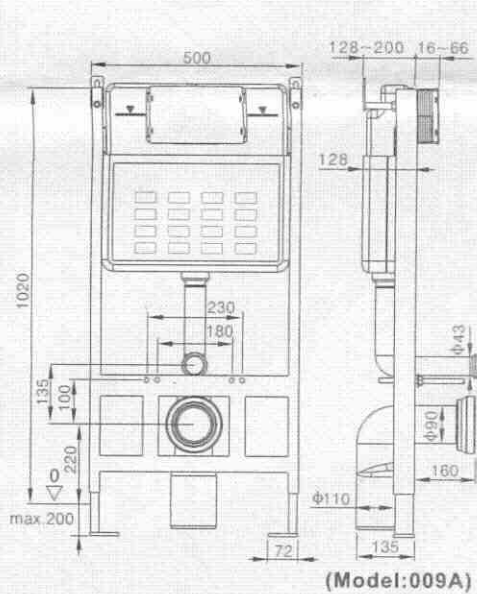

3. Technology specification of wall hunt toilet

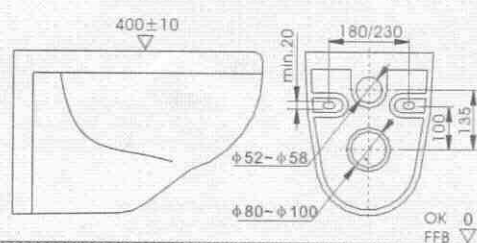

- The measure requirement of wall hung toilet:
- (1). The distance of the two hanging holes' centre is 180mm or 230mm.
 - (2). The distance between fill hole's centre and flush hole's centre is 135mm.
 - (3). The distance between flush hole's centre and hanging hole's centre is 100mm.
 - (4). The diameter of fill hole is $\phi 52\text{mm}-\phi 58\text{mm}$.
 - (5). The outer diameter of flush hole is $\phi 80\text{mm}-\phi 100\text{mm}$.
 - (6). The diameter of hanging hole can't less than $\phi 20\text{mm}$.
 - (7). The height from the top surface of wall hung toilet to the floor is 400mm (10mm more or less).

4. Install ways

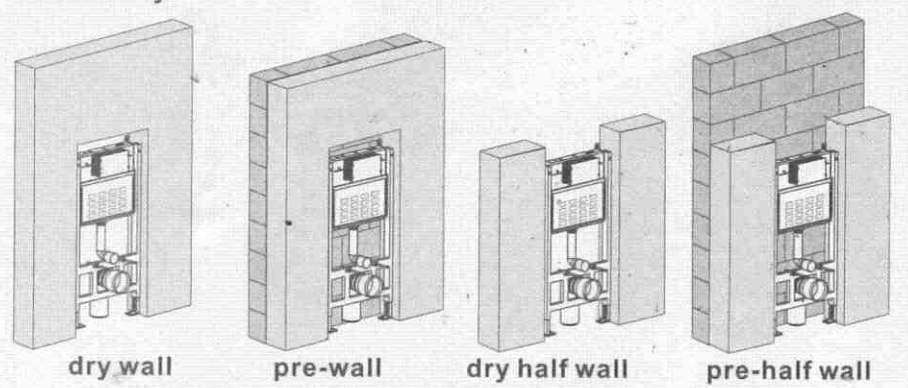

Attention: The wall which is installing the concealed cistern can be: brick beton; keel frame+plasterboard; keel frame+beaverboard; wooden frame.

5. Install steel frame

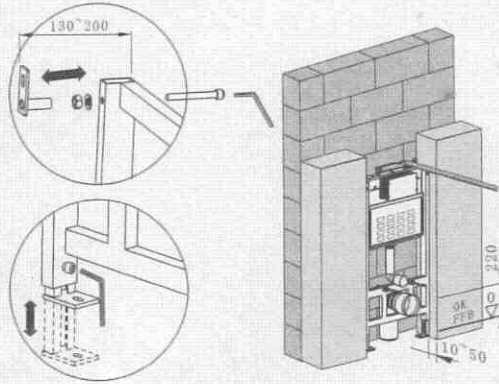

Adjust the adjustable poles longer or shorter

Adjust the balance and measure of steel frame, make mark on the position of drill hole.

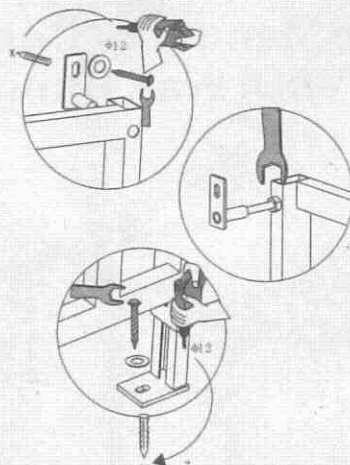

Drill hole, hit plastic nail into the hole, fix the steel frame by screw.

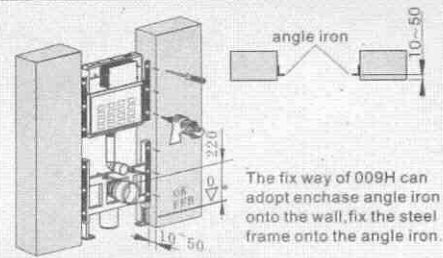

The fix way of 009H can adopt enchain angle iron onto the wall, fix the steel frame onto the angle iron.

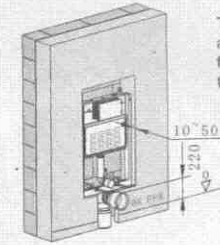

The fix way of 009V can adopt fill brick beton or keel frame under the steel frame to support the product.

6. Install flush pipe

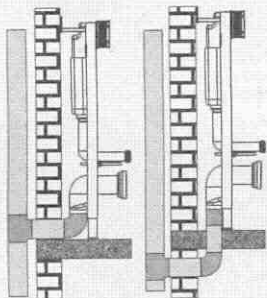

- ① pipe installed above the floor
- ② pipe installed under the floor

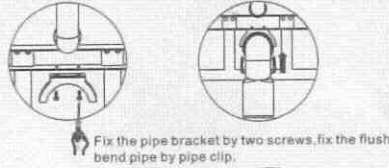

Fix the pipe bracket by two screws, fix the flush bend pipe by pipe clip.

The flush bend pipe can be turned to suitable position according to requirement.

The way of connect the flush bend pipe: HDPE plastic: weld the flush bend pipe by heated steel board, connect the flush bend pipe and flush pipeline by rubber tie-in. ABS plastic: smear glue onto the flush bend pipe, connect the flush bend pipe and flush pipeline by rubber tie-in.

7. Install fill water pipe

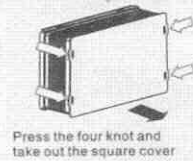

Press the four knot and take out the square cover

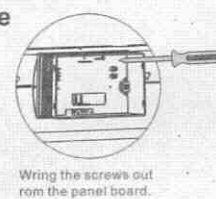

Wring the screws out from the panel board.



Catch the panel board, pull it upward and take it out aslant.



Connect the fill water pipe with angle iron and connect the metal soft pipe with angle iron

Attention: There may be much dirt in the new pipe, pls repeat open and close the stop valve several times, flush out the dirt by open & close the water source several times, till appear clean water. At the same time, pls wash the dirt in the cistern.

8. Preparative before build wall



Insert the panel board to the knot aslant

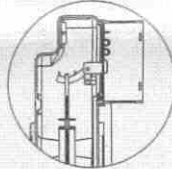

Insert the two hooks of panel board into the flush valve

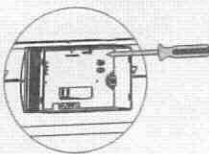

Twist the panel board with screw tightly

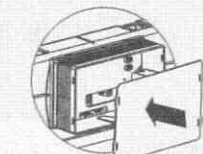

Cover the square cover (to prevent the dirty and prevent the deformation)

9. Build the wall

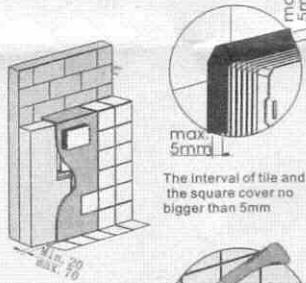

The interval of tile and the square cover no bigger than 5mm

Cover the system of concealed cistern by plasterboard or composite board. Stick tile onto the finished wall, the range of tile thickness is 20mm~70mm

Cut the part which protruding of tile flat with the wall

10. Install cistern panel

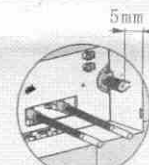

The surface of expanding pole is 5mm lower than the wall surface.



Adjust the outer part of pole to be about 28mm.

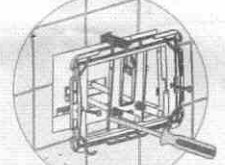

Fix the panel frame onto the expanding pole by screw.

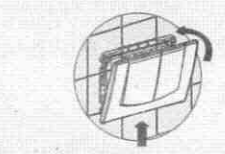

Buckle the bottom of cistern panel onto the panel frame, stress the cistern panel upward, close the cistern panel onto the panel frame.

11. Adjust straight pipe

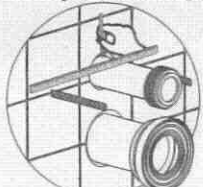

Insert the straight pipe into the bend pipe, make mark on the pipe where is balance to the wall.

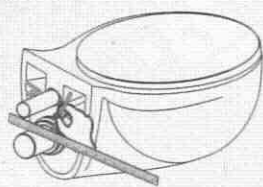

Insert the straight pipe into the hole of wall hung toilet, make mark on the pipe where is balance to the surface of wall hung toilet.

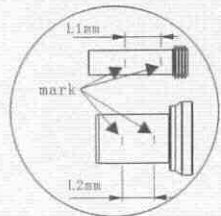

Measure the distance between the two marks.

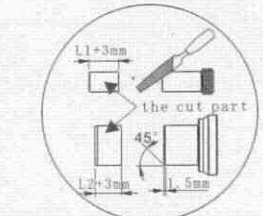

Measure the length of L+3mm at the edge of straight pipe and cut it down. Rub the cut edge of straight pipe by file to make it smooth.

12. Install wall hung toilet

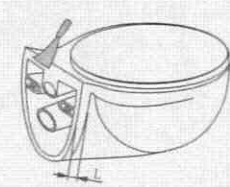

Measure the depth "L" of hanging hole of wall hung toilet, smear small white cement onto the side surface of wall hung toilet, where connecting to the wall.

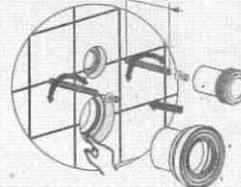

Smear silicon oil onto the sealed rubber of bend pipe equally, insert straight pipe into the bend pipe. Adjust the length of hanging pole, make the length of outside wall to be L+20mm. Fix the hanging pole by screw.

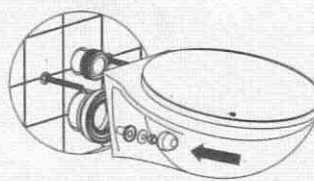

Install the wall hung toilet onto the hanging pole, set decorated ring, gasket, screw & decorated cap onto the hanging pole orderly.



Smear glass glue onto the side of wall hung toilet where connecting to the wall.

13. Install effect

